

FS120-EMERGENCY FUEL SHUT-OFF

Pilla Electrical Products, Inc.



DESCRIPTION:

Maintained, push-pull mushroom operator, 40mm dia. red, with engraved white lettering: "PULL TO RESET"

Bold luminous legends. External mounting feet top & bottom.

NEMA 4, 4X, 12.

Contact block capacity: for standard depth 1-3 per station, for XD version 6 per station.

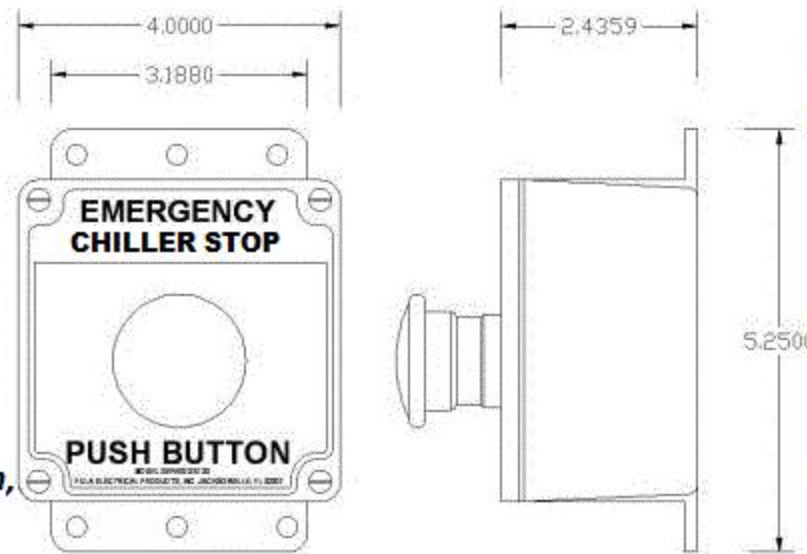

FS120IL



FS120CLM



FS120RP



PILNOCB



PILNCCB

RATED OPERATIONAL CHARACTERISTICS CONFORMING TO EC/EN 60947-5-1	AC SUPPLY: UTILIZATION CATEGORY AC-15	STANDARD BLOCKS (SINGLE OR DOUBLE) WITH SCREW CLAMP TERMINALS: A600: $U_e=600\text{Vac}$ AND $I_e=1.2\text{ A}$ OR $U_e=240\text{ Vac}$ AND $I_e= 3\text{ A}$ OR $U_e = 120\text{ Vac}$ AND $I_e = 6\text{ A}$ CONTINUOUS THERMAL CURRENT 10 A	
	DC SUPPLY: UTILIZATION CATEGORY DC-13	STANDARD SINGLE OR DOUBLE BLOCKS WITH SCREW CLAMP TERMINALS: Q600: $U_e= 600\text{VdC}$ AND $I_e = 0.1\text{ A}$	
		24 Vdc	0.5 A

AVAILABLE OPTIONS:

FS120MPGM
FS120GM
Guard for (standard) type MP and optional suffix TW/KR/MO 40mm mushroom operator, lockable
(RED METAL GUARD)



FS120 with PILCLHCOV1
One Clear Hinged Cover fits all one device/push button model series and one-two device/Power Control series, provision for padlock/seal



FS120MO
Momentary 40mm mushroom model



FS120KR
Key Release 40mm mushroom model with two keys, key required to reset.



FS120MPGM(y)
Guard for (standard) type MP and optional suffix TW/KR/MO 40mm mushroom operator, lockable
(YELLOW NONMETALLIC GUARD)

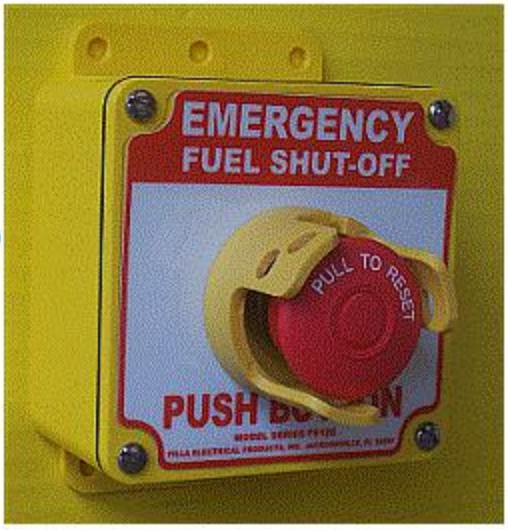

FS120TW
Maintained "TURN TO RESET" 40mm mushroom model



FS120MDYCLM-30
Switch 12 A @ 120V AC
10 V @ 24v DC
(pilot duty-inductive loads).
Start/Stop Motors:
1.5 PH @ 120V AC
3PH @ 240V AC
10A FLA/60A LRA @ 24V DC.
Available in N.O. or N.C. configuration.
Terminals accept up to 10 AWG wires.



UL LISTED 9F36 (CANADA)

FS120XD
Extra depth option: Capacity 6 single pole contact block.
Extra depth version type MP(standard), also available for all optional suffix TW/KR/MO.



PILNCCB		PILNOCB	
----------------	---	----------------	---

FS120MPGM(y) RATED OPERATIONAL CHARACTERISTICS CONFORMING TO EC/EN 60947-5-1	AC SUPPLY: UTILIZATION CATEGORY AC-15	STANDARD BLOCKS (SINGLE OR DOUBLE) WITH SCREW CLAMP TERMINALS: A600: Ue=600Vac AND Ie=1.2 A OR Ue=240 Vac AND Ie= 3 A OR Ue = 120 Vac AND Ie = 6 A CONTINUOUS THERMAL CURRENT 10 A	
	DC SUPPLY: UTILIZATION CATEGORY DC-13	STANDARD SINGLE OR DOUBLE BLOCKS WITH SCREW CLAMP TERMINALS: Q600: Ue= 600VdC AND Ie = 0.1 A	
		24 Vdc	0.5 A